

# > JET

## Wall Axial Fans



Comply with  
ErP Directive 2009/125/CE  
and EU Regulation 1253/2014  
(Classification: Residential Ventilation Unit)



### DESCRIPTION

JET is an axial fan suitable for exhausting air directly to the outside or through short length ducting and adapted for wall and panel installation in bathrooms, toilets, utility rooms, kitchens and so on.

### FEATURES

- Manufactured in shock-proof high quality technopolymer
- Maintenance-free, self lubricating sleeve bearing motor for long life and noiseless running
- Induction motor with overheating protection 230V-50Hz
- Available sizes: 4", 5", 6" (100/120/150 mm)
- Easy installation, maintenance and cleaning
- IPX2 protected
- Suitable for operation in max. ambient temperature of +40°C
- Double insulation: no earth connection is needed
- Speed controllable
- Complies with IEC 60335-2-80, LVD 2014/35/UE and EMC 2014/30/UE

### VERSIONS



**STANDARD** - On/Off via light/remote control switch.



**PULL CORD SWITCH** - On/Off via pull cord switch.



**TIMER** - Integral electronic timer adjustable from 3 to 25 minutes.

## SPECIFICATION

JET

Model	m <sup>3</sup> /h	l/s	Pa	W	dB (A)*
JET 4/100	90	25	18	11	39
JET 5/120	175	49	35	15	43
JET 6/150	320	89	71	40	51

\*Lp(A) measured at 3m in open field 230V-50Hz.

## CURVES

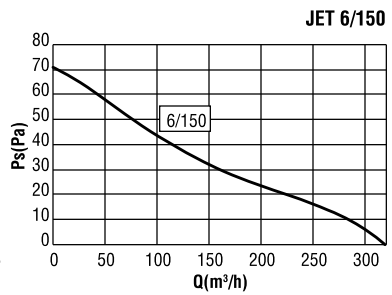
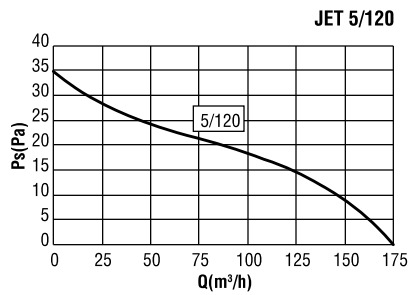
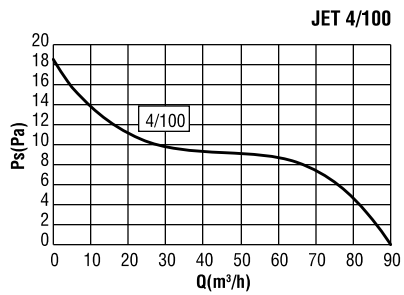
**JET**

## DIMENSIONS

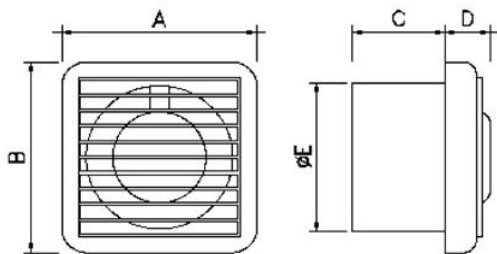
**JET**

Model	A	B	C	D	ØE	Kg*
<b>JET 4/100</b>	125	125	63	29	97	0,8
<b>JET 5/120</b>	150	150	73	29	118	1,2
<b>JET 6/150</b>	185	185	93	29	151	1,5

\*Net Weight

## INSTALLATION

**JET**
